

# Anti-Theft Alarm

## CE-A01 User Manual



### 1, Parameter:

Voltage: DC 9V

Sound Pressure:  $\geq$  105-130DB

Device dimension: 98\*46\*22mm

Remote control dimension: 64\*38.5\*14mm

Wireless distance: 30M (open sky)

Working temperature: -10°C -- 55°C

Store temperature: -25°C -- 65°C

### 2, Function:

Anti-theft alarm.

There is a vibration sensor in the device, in the condition of defence, when the device is vibrated, it will alarm loudly, the theft will feel afraid and give up. On the other hand, the owner will be alert when hearing the alarm.

### 3, Application:

It can be widely used, for example:

Bicycle, Electric vehicle, Motorbike, Vehicle; Door, Window, Safety box and so on.

### 4, How to use it:

1), There are 3 pictures shows the keypad function.

2), How to set up defences?



Re: Turn on the device

-- Press set up defences



3) How to Disarming?



Press "Disarming"

4), How to set up voice grade

Re: There are 3 grade voice, Under the condition of "turn on" the device, the steps to set up voice grade is: Press



"Disarming" more than 2 seconds – then you can here three grades voice, big, middle, and small voice. And choose from them. For example, if you want big voice, when you hear the big voice, stop press the

disarming keypad. (The default is big grade voice)

**5), How to set up vibration Sensitivity:**



Re: There are 5 grades of sensitivity, press “Doorbell alarm” for 2 seconds, you will hear: beep, beep 2 times, beep 3 times, beep 4 times and beep 5 times, Beep one time is the most sensitive, beep 5 times is the least sensitive. (The default is most sensitive)

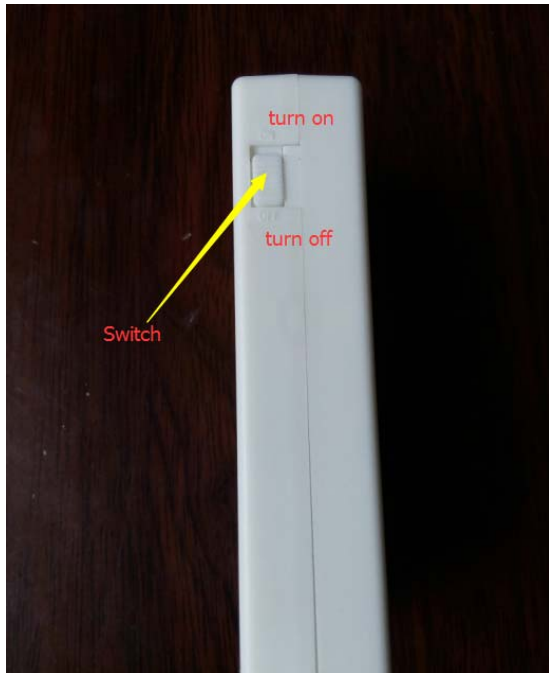

Picture 1



Picture 2

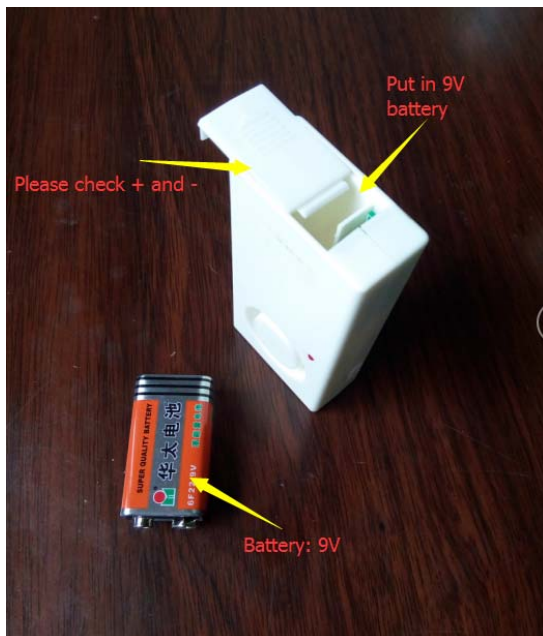

Picture 3

**6, Warranty: 2 years from shipping day.**